

The logo for HORNE, featuring the word "HORNE" in white, bold, uppercase letters on a teal rectangular background.

Horne Engineering Ltd
PO Box 7, Rankine Street
Johnstone, Scotland, PA5 8BD
t: +44 (0)1505 321455
f: + 44 (0)1505 336287
e: technical@horne.co.uk
w: horne.co.uk

Horne Steam/Water Mixing Valve, SWM1-10
Spares Kits and Components
(for item numbers refer to drawing no 8348 on page 3)

Kits

Part Number	Description
5569	Spares Kit – contains Items below marked *
71-6556	Overheat Piston Sub Assembly – contains items below Marked †
43-4973	Swivel Adaptor (1 set) Gun to Hose attachment
44-4972	Spray Gun

Valve Components

Part No	Drawing Ref	Description
23-4913	1*	Rolling Element Diaphragm
20-4911	2	Water Inlet Housing
20-4910	3	Water Distributor Housing
41-4915	4	Inlet Housing Screw (M8 x 20 SKT Head Cap) (6 required per Valve)
42-4916	5*	Water Distributor Seal
41-4917	6	Valve Body Screw (M8 x 18 Hex Head) (6 required per Valve)
20-4909	7	Steam Valve Body
23-4918	8*	Steam Valve Seat
41-4921	9	Overheat HSG Screw (M6 x 28 SKT Head Cap) (6 required per Valve)
42-4919	10*	Overheat Housing Seal
42-4920	11*	Overheat Housing Face Seal
40-5149	12	Element Loading Spring
20-4912	13	Overheat Protection Housing
20-5148	14	Element Spring Seat
42-4922	15*†	Adjustment/Overheat Piston Seal (2 required per Valve)
20-4923	16†	Adjustment/Overheat Piston
20-4924	17†	Element Shroud
20-4925	18	Adjustment Lockshield
20-4926	19	Adjusting Screw
46-4955	20	Serial Number Label
40-4928	21†	Overheat Spring
20-4959	22†	Overheat Spring Retaining Nut
44-4930	23*	Thermostat Element
20-4931	24	Thermostat Rod
20-4932	25	Steam Seal Housing

42-4933	26*	Steam Seal Housing Seal
42-4934	27*	Steam Seal
20-4935	28	Steam Seal Retaining Plate
41-2085	29	Steam Seal Retaining Plate Screw (2 required per Valve)
20-4940	30	Steam Valve Disc & Lifting Rod
46-4742	31	Nameplate
41-2065	32	Fixing Screw (4 required per Valve)
42-4943	33*	By-Pass Pipe Seal (2 required per Valve)
20-4942	34	By-Pass Pipe
23-4944	35*	By-Pass Valve Spool
40-4945	36*	By-Pass Valve Spring
20-4946	37	By-Pass Valve Spool Guide
42-4947	38*	By-Pass Housing Seal
41-4948	39	Wave Spring
20-4949	40	Wave Spring Support Washer (2 require per Valve)
41-5168	41*	Diaphragm Retaining Pin
20-4952	42	Water Piston Housing
20-4960	43	Diaphragm Retaining Nut
20-4953	44	Water Piston

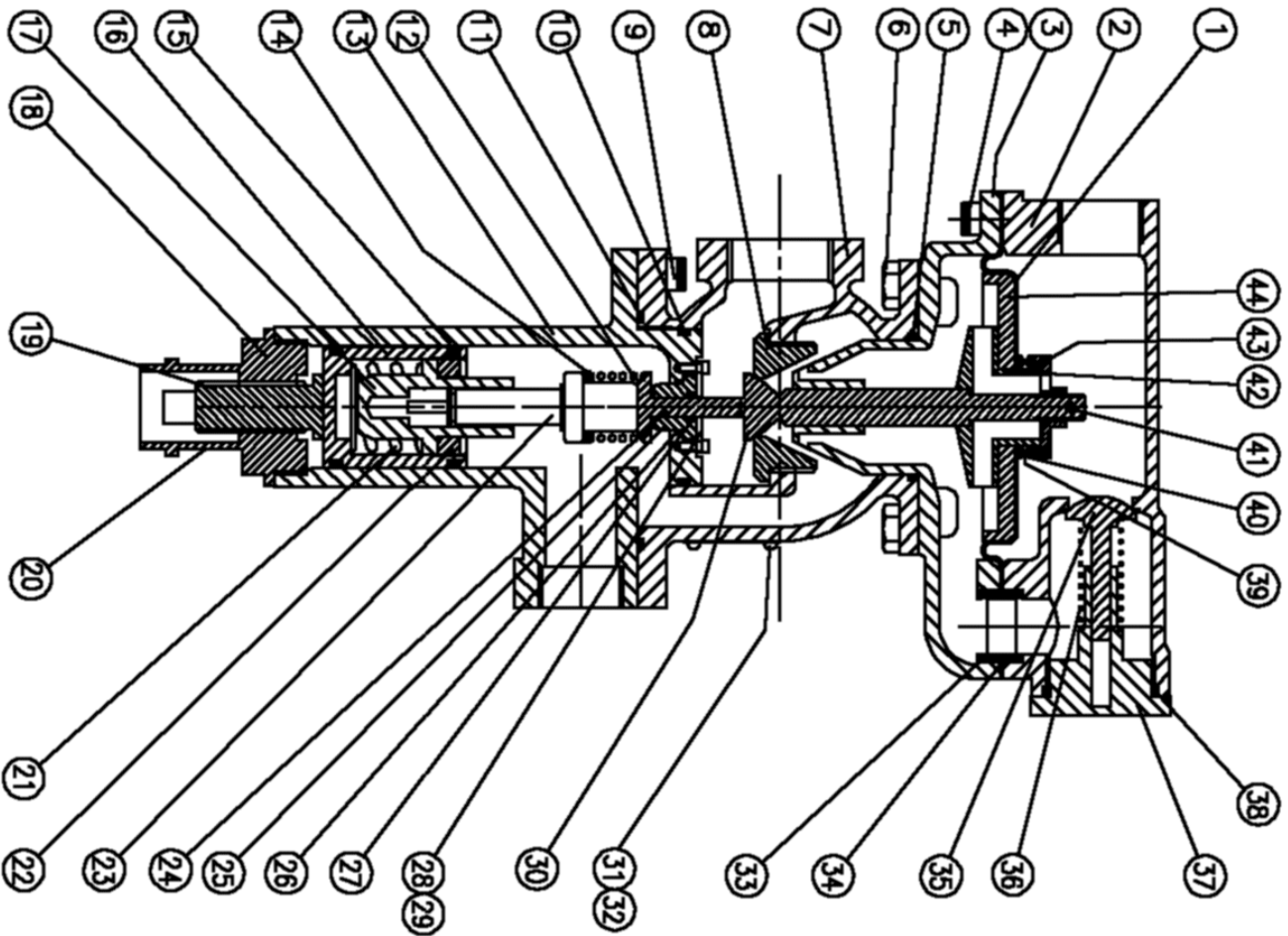

ITEM No.	QTY	DESCRIPTION
1	1	ROLLING ELEMENT DIAPHRAGM
2	1	WATER INLET HOUSING
3	1	WATER DISTRIBUTOR HOUSING
4	6	INLET HOUSING SCREW (M8 X 20 SKT HEAD CAP)
5	1	WATER DISTRIBUTOR SEAL
6	6	VALVE BODY SCREW (M8 x 12 HEX HEAD)
7	1	STEAM VALVE BODY
8	1	STEAM VALVE SEAT
9	6	OVERHEAT HOUSING SCREW (M6 x 18 SKT HEAD CAP)
10	1	OVERHEAT HOUSING SEAL
11	1	OVERHEAT HOUSING FACE SEAL
12	1	ELEMENT LOADING SPRING
13	1	OVERHEAT PROTECTION HOUSING
14	1	ELEMENT SPRING SEAT
15	2	ADJUSTMENT / OVERHEAT PISTON SEAL
16	1	ADJUSTMENT / OVERHEAT PISTON
17	1	ELEMENT SHROUD
18	1	ADJUSTMENT LOCKSHIELD
19	1	ADJUSTING SCREW
20	1	SERIAL NUMBER LABEL
21	1	OVERHEAT SPRING
22	1	OVERHEAT SPRING RETAINING NUT
23	1	THERMOSTAT ELEMENT
24	1	THERMOSTAT ROD
25	1	STEAM SEAL HOUSING
26	1	STEAM SEAL HOUSING SEAL
27	1	STEAM SEAL
28	1	STEAM SEAL RETAINING PLATE
29	2	STEAM SEAL RETAINING PLATE SCREW
30	1	STEAM VALVE DISK & LIFTING ROD
31	1	NAMEPLATE
32	4	FIXING SCREWS
33	2	BY-PASS PIPE SEAL
34	1	BY-PASS PIPE
35	1	BY-PASS VALVE SPOOL
36	1	BY-PASS VALVE SPRING
37	1	BY-PASS VALVE SPOOLGUIDE
38	1	BY-PASS VALVE HOUSING SEAL
39	1	VALVE SPRING
40	2	VALVE SPRING SUPPORT WASHER
41	1	DIAPHRAGM RETAINING PIN
42	1	WATER PISTON HOUSING
43	1	DIAPHRAGM RETAINING NUT
44	1	WATER PISTON

COPYRIGHT 2002, HORNE ENGINEERING LTD. ALL REPRODUCTION PROHIBITED UNLESS AUTHORISED IN WRITING

MATERIAL : -		HORNE ENGINEERING LTD.	
PART : -		JOHNSTONE	
GENERAL ARRANGEMENT AND PARTS LIST		RENFREWSHIRE	
PRODUCT : SWM1 THERMOSTATIC STEAM AND WATER MIXING VALVE		SCALE	DO NOT SCALE
		DRAWN	GDP 27/8/02
		CHECKED	
		ISSUE	5
		DR'G. No. 8348	

THIS DRAWING CONTAINS CONFIDENTIAL AND PROPRIETARY INFORMATION OF HORNE ENGINEERING LTD AND UNAUTHORISED DISCLOSURE IS STRICTLY PROHIBITED.