



Pipe Cover Kit for Aluminium Shower Panels

INSTALLATION INSTRUCTIONS

Installation requirements and specifications

Note that this Pipe Cover Kit is **ONLY** suitable for the Horne Range of **Aluminium** Shower Panels. It is not suitable for the Horne Range of Stainless Steel Panels; a separate Pipe Cover Kit is available to suit the Stainless Steel panel range.

There are two different lengths of Pipe Cover Kit available for Aluminium Shower Panels – 465mm long and 940mm long. Please ensure that you have the appropriate length for your application.

Ensure that you have been supplied with the correct Pipe Cover Kit and that the Pipe Cover is long enough to fully cover the gap between the panel and the ceiling.

Fit the Aluminium Shower Panel to the wall in accordance with the Installation Instructions supplied with it.

Identify the components of the kit by comparing the contents with the drawing shown on the Page 4. If you have fitted an End Cap on the top of the shower panel, remove it as the Pipe Cover replaces this.

Fit the Width Brace (Item 8) by nesting it on top of the bracing strut across the top of the shower panel. Mark out the securing hole and attach the Width Brace using the supplied screw (Item 7). Use a wall plug (not supplied) if necessary, depending upon your wall material.

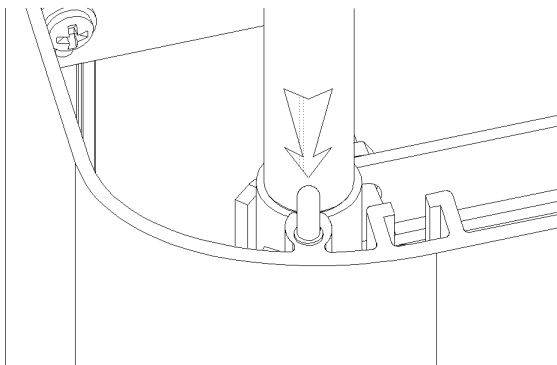

Put the two Alignment Pins (Items 6) into the circular recesses in the Channel Section of the Shower Panel. See Fig 1.

Fig. 1

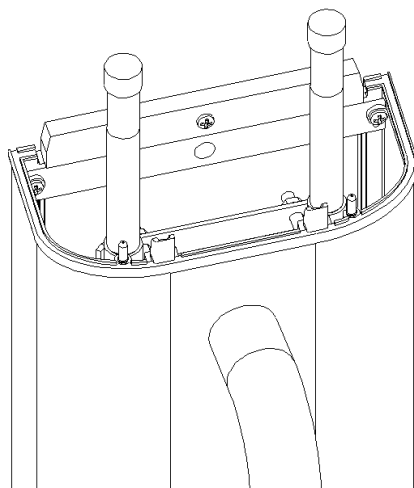

Place the shaped Gasket (Item 5) onto the top of the Shower Panel, noting that it only fits one way, and that the rectangular legs engage with the rectangular recesses in the Channel Section of the Shower Panel. See Fig 2.ig 2

Fig.2

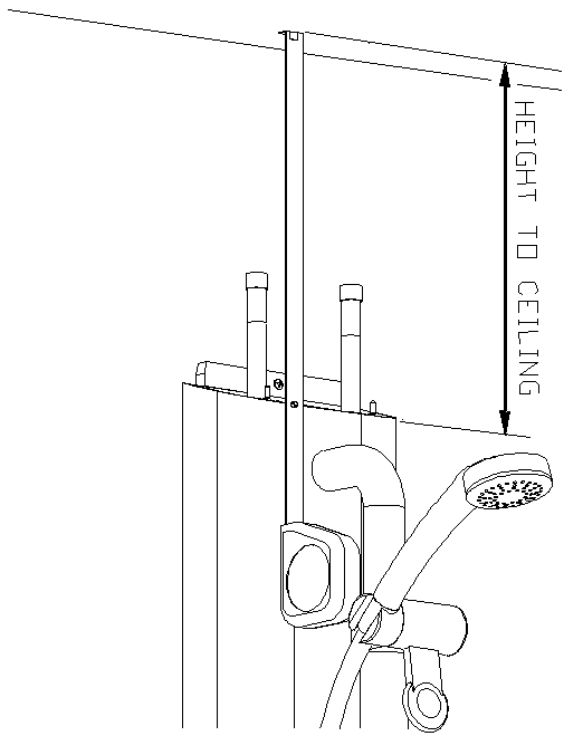

Fig. 3

Slide the Pipe Cover down into Place and check for fit. The top of the Pipe Cover should be approx 15mm from the ceiling when pressed firmly into place. Position the Saddle over the top of the Pipe Cover with the hole in its lower position. Mark through the hole in the Saddle onto the Pipe Cover. See Fig. 5

Remove the Saddle (Item 3) and Pipe Cover (Item 4) and drill the Pipe Cover (Item 4) with a 7 mm drill where marked. See Fig. 6. Replace the Saddle (Item 3) and Pipe Cover (Item 4) and put in the screw to mark the wall. If appropriate, drill the wall to take the screw, or fit appropriate wall plugs. NB. If the pipe drops have not been connected then it is essential that the red plastic pipe covers are in place on the end of the pipes in the Shower Panel to prevent debris from entering the pipes.

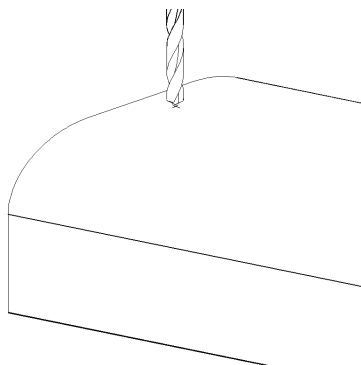

Fig.6

Slide the Pipe Cover (Item 4) down into place, engaging with both the Alignment Pins (Items 6) and the Gasket (Item 5). If the Pipe Cover is too long to do this, then measure the gap between the ceiling and the panel and cut the square TOP end of the Pipe Cover to make the Pipe Cover 15mm **SHORTER** than the gap using a saw suitable for use with aluminium. **NB. DO NOT CUT THE ANGLED END OF THE PIPE COVER** or it will not fit neatly onto the top of the Shower Panel. See Fig. 3 and 4.

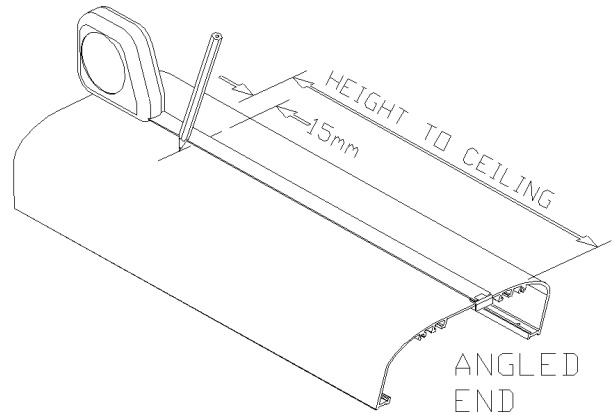

Fig. 4

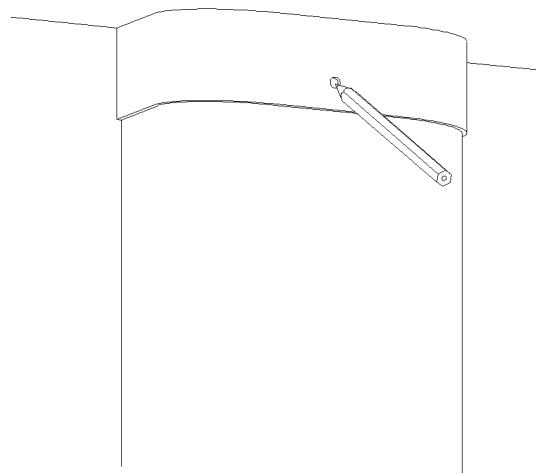

Fig. 5

Finally, assemble the saddle to the cover by putting the Pin Torx Security Screw (Item 1) through the Screw Cup and through the Saddle and Pipe Cover.

Do not over-tighten the Pin Torx screw or the Saddle edges will splay out and give a poor appearance.

Silicon sealer can be used at the joint edges if required.

The drawing on Page 3 shows the exploded assembly view of the Pipe Cover and Saddle installation.

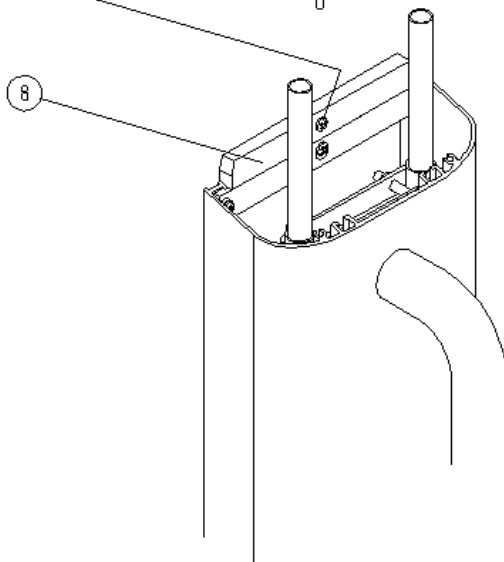
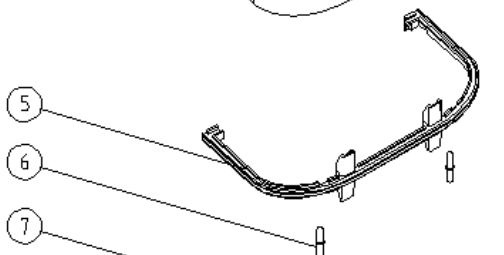
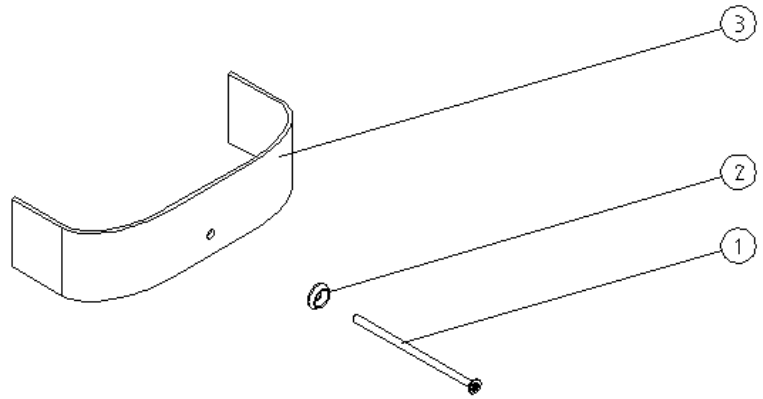
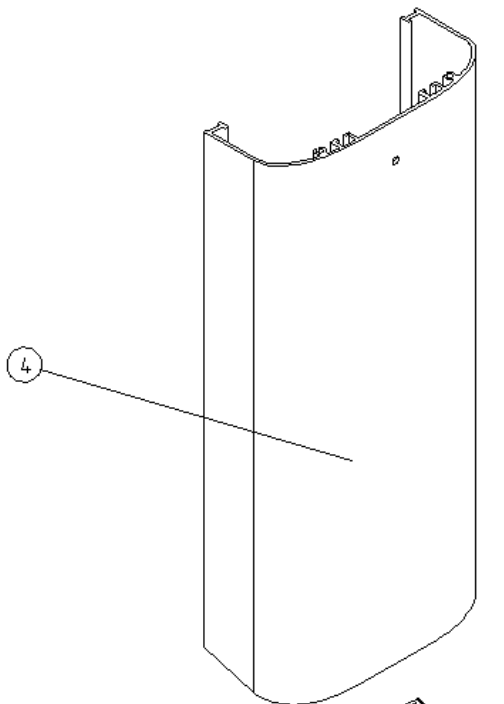

ITEM	DESCRIPTION	No OFF
1	PIN TORX SECURITY SCREW	1
2	SCREW CUP	1
3	SADDLE	1
4	940mm PIPE COVER (465mm or 940mm)	1
5	GASKET	1
6	ALIGNMENT PIN	2
7	WIDTH BRACE SCREW	1
8	WIDTH BRACE	1

COPYRIGHT 2009, HORNE ENGINEERING LTD. ALL REPRODUCTION PROHIBITED UNLESS AUTHORISED IN WRITING

THIS DRAWING CONTAINS CONFIDENTIAL AND PROPRIETARY INFORMATION OF HORNE ENGINEERING LTD AND UNAUTHORISED DISCLOSURE IS STRICTLY PROHIBITED

MATERIAL : -

HORNE ENGINEERING LTD.
JOHNSTONE
RENFREWSHIRE

PART :
PIPE COVER KIT

PRODUCT :
ALUMINIUM SHOWER
PANELS

SCALE	DO NOT SCALE
DRAWN	GDP 17-6-09
CHECKED	
ISSUE	3

DR'G. No. 10334

Brochure Ref: L-190

Horne Engineering Ltd
PO Box 7, Rankine Street
Johnstone, SCOTLAND
PA5 8BD
Tel: +44 (0)1505 321455
Fax: +44 (0)1505 336276
Email: technical@horne.co.uk
www.horne.co.uk