

HORNE®

Horne Engineering Ltd
PO Box 7, Rankine Street
Johnstone, Scotland, PA5 8BD
t: +44 (0)1505 321455
f: + 44 (0)1505 336287
e: technical@horne.co.uk
w: horne.co.uk

TSV1-3 Shower Valve Spare Parts (refer to drawing 8341/7 on page 3)

Kits

Part Number	Description
4579	Element & Spring Assembly
4983 (includes * marked items)	Full Seals Kit
4979	Full Spares Kit

Valve Components

Part Number	Drawing Ref	Description
5671	1 - 6	Inlet Assembly
43-5019	4	Strainer Basket (E & D Type - circular in section, debossed)
43-4753	4	Strainer Basket (B Type - square in section, no deboss)
20-4661	7	Baffle Tube
40-4662	8	Return Spring
42-3849	9*	Slide Valve Seal (in body)
71-4190	10	Slide Valve Sub-assembly
4579	11-12	Thermostat Element and element spring
42-2834	13*	Valve Cover Seal
71-5888	13-21, 25	Valve Cover Assembly with Locknut
41-5883	21	Temperature Knob Adaptor Circlip
23-5672B	22	Temp Spacer Clamp Ring - Alu panels (standard & 2L controls)
23-5672D	22	Temp Spacer Clamp Ring - ligature resistant (LR) Alu panels
23-5672D	22	Spacer Clamp Ring - stainless steel panels

Cont'd

Part Number	Drawing Ref	Description
70-4406	24	Temperature Knob
20-5767	25	Temperature Knob Locknut
23-4263	26	Temperature Knob Cap
23-4264	27	On-off Knob Cap
41-4162	28	On-off Knob Screw
20-4246	29	On-off Knob Spacer
70-4407	30	On-off Control Knob
23-5672A	32	Spacer clamp ring (On-off side) - Alu panels (standard & 2L controls)
23-5672C	32	Spacer clamp ring (On-off side) - ligature resistant (LR) Alu panels
23-5526C	32	Spacer clamp ring (On-off side) - stainless steel panels
44-4174	34-37	On-off sub-assembly
4889	7-21 34-39	Replacement valve body (populated) - to suit standard and ligature resistant (LR) controls
5765	7-21 34-39	Replacement valve body (populated) - to suit lever (1/4 turn headworks) controls
5915	n/a	BS 8300 compliant lever controls for retrofitting (includes ceramic disc cartridge)
44-5406	n/a	Ceramic disc on-off cartridge for 2L variants

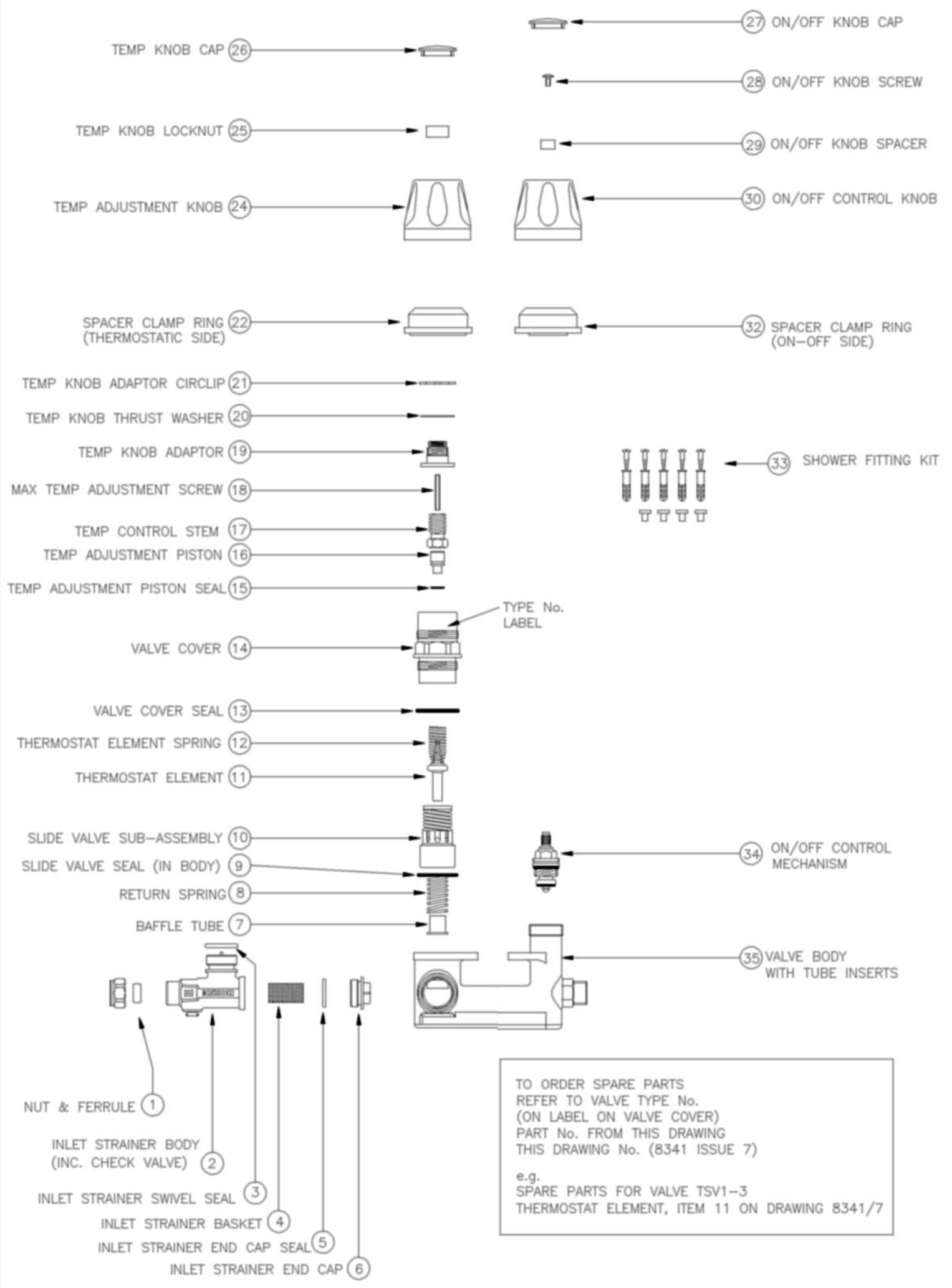

TO ORDER SPARE PARTS
 REFER TO VALVE TYPE No.
 (ON LABEL ON VALVE COVER)
 PART No. FROM THIS DRAWING
 THIS DRAWING No. (8341 ISSUE 7)
 e.g.
 SPARE PARTS FOR VALVE TSV1-3
 THERMOSTAT ELEMENT, ITEM 11 ON DRAWING 8341/7